

Horizontal Proportional Counter (HPC)

* Detector Drawing (sorry in Japanese)

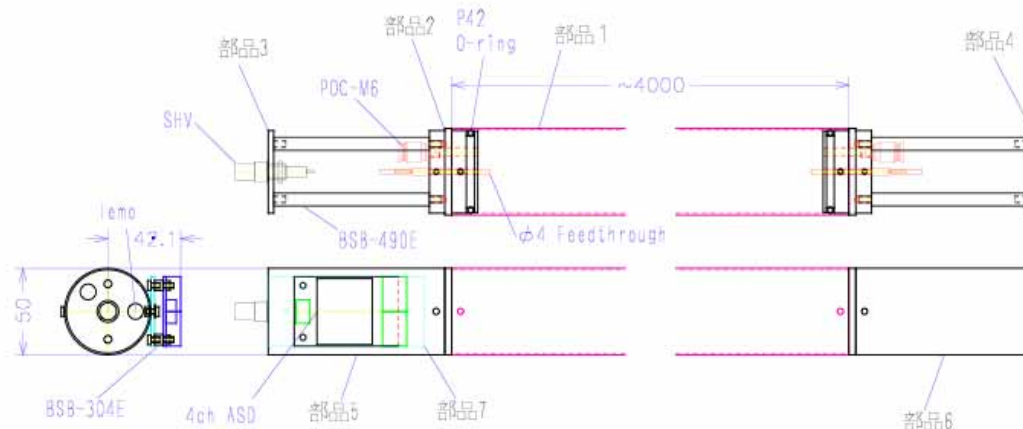

* Detector Stand for Cosmic-Ray test

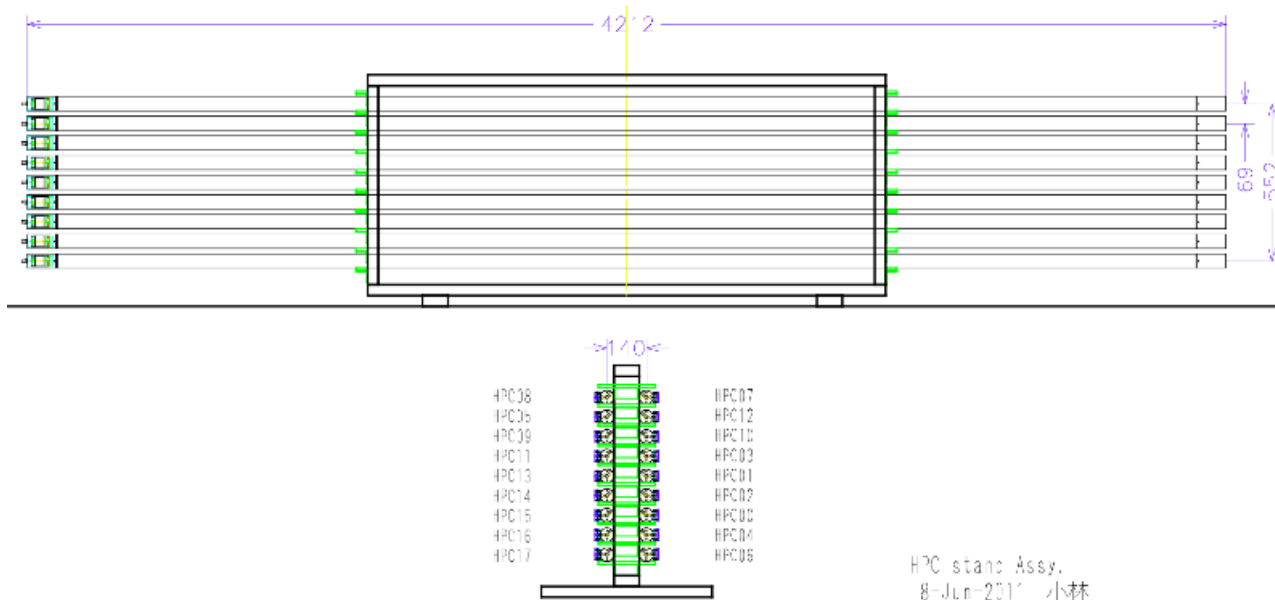

- * High voltage Plateau using cosmic-ray muon
- * Gas : P10 (Ar + 10% CH4)
- * Amp/Shaper/Discriminator threshold : -0.8V
- * Coincidence window width : 1 μ sec
- * Trigger rate : ~ 5 Hz (~ 5 min at one voltage, ~ 1 hour for one detector)

